

YD-V36

speakerphone

with cup holder mount

User Manual
v1.0

www.letsyada.com

▶ Thank You

Thank you for purchasing the latest Yada wireless technology product from Winplus. We hope you will enjoy all features and benefits offered by the YD-V36 Speakerphone. These features and benefits were designed with the goal of making wireless communication more convenient for the user.

Winplus USA

820 South Wanamaker Avenue, Ontario, CA 91761
customercare@winplususa.com
www.winplususa.com

Winplus Europe

Unit 4, Two Counties Estate, Falconer Road,
Haverhill, Suffolk CB9 7XZ, U.K.
info@winplus-europe.com
www.winplus.net

Winplus Asia

Suites 6-11, 7th Floor, Corporation Park,
11 On Lai Street, Shatin, N.T., Hong Kong
info@winplus.net
www.winplus.net

Winplus Australia

Unit 2, 991 Mountain Hwy Boronia,
Victoria, Australia, 3155
customercare@winplus.com.au
www.winplus.com.au

Winplus New Zealand

Griffiths Equipment
22-24 Olive Road, Penrose, Auckland, New Zealand
web@griffiths.co.nz
www.types.co.nz

► Contents

- 1 SPECIFICATIONS
- 2 DISCLAIMER
- 3 WARRANTY / LIABILITIES
- 4 PACKAGE CONTENT
- 5 INSTALLATIONS
- 6 BATTERY OPERATIONS
- 7 OPERATIONS
- 8 BUTTON FUNCTIONS AND OPERATION
- 9 CARE AND MAINTENANCE
- 10 TROUBLE SHOOTING
- 11 CUSTOMER SERVICE / CONTACT US
- 12 FCC / ICC

Specifications

- Bluetooth® Spec.: v2.1 + EDR
- Weight: 98g
- Talk Time: 8 Hours
- Standby Time: 100 Hours
- Profiles Support: Headset & Handsfree
- Operating Range: 10 Meters
- Operation Voltage: 5V, 350mA
- Battery: Li-Polymer
- Noise / Echo Reduction: CVC Noise & Echo Reduction
- Volume Control level: 16 Levels
- Operating Temperature: -10°C to 45°C
- Storage Temperature: -20°C to 60°C

▶ Disclaimer

- Distracted driving is dangerous. Always use the Bluetooth® Device in a manner that does not reduce your attention and ability to drive carefully and safely.
- Adhere to all applicable traffic laws and motor vehicle regulations applicable to the device.
- Consult local laws and regulations for any restrictions on installation or use.
- Do not install on or near an airbag. Such installation could interfere with airbag deployment or could cause the product or another object to become a projectile, which could result in serious personal injury to occupants.
- Ensure the product location will not obstruct your vision while driving.
- Observe all signs that require an electrical device or RF radio product to be switched off in the designated areas. These could include hospitals, blasting areas, and potentially explosive atmospheres.
- Turn off your device prior to boarding an aircraft. Do not use your device in an aircraft.
- Never allow children to play with the device. Small parts may be a choking hazard.

Warranty / Liabilities

WINPLUS NORTH AMERICA

LIMITED WARRANTY

Winplus North America warrants, to the original purchaser, that its products are free from defects in material and workmanship for 1 year from the date of original purchase. Where permitted by law, Winplus North America's liability shall be limited to that set forth in this limited express warranty. This limited express warranty shall be the exclusive remedy of the purchaser and Winplus North America makes no other warranty of any kind aside from the limited express warranty stated above.

NOTE: Warranty only applies for North American customers or purchases made in the North America.

CONDITIONS OF WARRANTY

If during the 1 year warranty period your new product is found to be defective, Winplus North America will repair such defect, or replace the product, without charge for parts or labor subject to the following conditions:

1. All repairs must be performed by Winplus North America.
2. All warranty claims must be accompanied by a copy of the sales receipt or bill of sale.
3. The equipment must not have been altered or damaged through negligence, accident, improper operation, or failure to follow the product instructions for installation, use, or care.

4. The replacement of parts is excluded from the warranty when replacement is necessary due to normal wear and tear.
5. Repair or replacement parts supplied by Winplus North America under this warranty are protected only for the unexpired portion of the original warranty.
6. This is a “repair or replace” warranty only, and does not cover the costs incurred for the installation, removal or reinstallation of the product, or damage to any mobile phone device or vehicle.

OWNER'S RESPONSIBILITIES:

Winplus North America will make every effort to provide warranty service within a reasonable period of time. SHOULD YOU HAVE ANY QUESTIONS ABOUT SERVICE RECEIVED OR IF YOU WOULD LIKE ASSISTANCE IN OBTAINING SERVICE, PLEASE CALL TOLL FREE 1.866.294.9244 DURING REGULAR BUSINESS HOURS MONDAY THROUGH FRIDAY 9:00 AM TO 5:00PM.

NOTE: Toll Free # is for North America Customers ONLY. See Customer service section for customer contact numbers for other regions/offices.

In order to provide you with the proper warranty service, we request that you adhere to the following procedure:

1. Include a copy of your sales receipt or bill of sale with your unit when it is returned for warranty service.
2. If it is necessary to return your product for service, please return it securely packed, preferably in the original shipping box, and freight and insurance prepaid to the following address:

ATTN: CUSTOMER CARE PRODUCTS RETURNS
820 South Wanamaker Ave.
Ontario, CA 91761

3. Please include a detailed explanation of the problem you are having.
4. If your product is found by Winplus North America to have a defect in material or workmanship, within the warranty period, it will be repaired or replaced at no charge and returned to you prepaid.

Winplus North America makes no other warranty of any kind aside from the limited express warranty stated herein.

DISCLAIMER OF WARRANTIES, INCLUDING WARRANTY OF MERCHANTABILITY AND WARRANTY OF FITNESS FOR PARTICULAR PURPOSE: EXCEPT AS SPECIFICALLY SET FORTH HEREIN, NO WARRANTY OR REPRESENTATION, EXPRESS OR IMPLIED, IS MADE AS TO THE YD-V36 SPEAKERPHONE. EXCEPT AS EXPRESSLY SET FORTH HEREIN, WINPLUS NORTH AMERICA AND/OR ITS AFFILIATES EXPRESSLY DISCLAIMS, WITHOUT LIMITATION, ANY STATUTORY WARRANTIES AND ALL IMPLIED WARRANTIES, INCLUDING ANY IMPLIED WARRANTY OF MERCHANTABILITY OR FITNESS FOR A PARTICULAR PURPOSE.

Winplus North America and/or its affiliates are not responsible for a user's intended or actual use of the YD-V36 Speakerphone. In no event shall Winplus North America and/or its affiliates have any liability for any losses (whether direct or indirect, in contract, tort or otherwise) incurred in connection with the YD-V36 Speakerphone. Neither shall Winplus North America and/or its affiliates have any liability for any decision, action or inaction taken by any person in reliance on the YD-V36 Speakerphone, or for any delays, inaccuracies and/or errors in connection with the YD-V36 Speakerphone and its functioning.

Winplus North America and/or its affiliates shall have no responsibility or liability for damage and/or injury resulting from accidents while user is utilizing the YD-V36 Speakerphone; and Winplus North America and/or its affiliates, the manufacturer, distributor and seller shall not be liable for any injury, loss or damage, incidental or consequential, arising out of the use or intended use of the product.

WINPLUS EUROPE

LIMITED WARRANTY

Winplus warrants, to the original purchaser, that its products are free from defects in material and workmanship for 12 months from the date of original purchase. Where permitted by law, Winplus liability shall be limited to that set forth in this limited express warranty. This limited express warranty shall be the exclusive remedy of the purchaser and Winplus makes no other warranty of any kind aside from the limited express warranty stated above.

OWNER'S RESPONSIBILITIES:

In order to provide you with the proper warranty service, we request that you adhere to the following procedure:

1. Include a copy of your sales receipt or bill of sale with your unit when it is returned for warranty service.
2. If it is necessary to return your product for service, please return it securely packed, preferably in the original shipping box, and freight and insurance prepaid to the following address:
**ATTN: WINPLUS BLUETOOTH PRODUCTS RETURNS
Unit 4, Two Counties Estate, Falconer Road,
Haverhill, Suffolk CB9 7XZ, UK**
3. Please include a detailed explanation of the problem you are having.
4. If your product is found by Winplus to have a defect in material or workmanship, within the warranty period, it will be repaired or replaced at no charge and returned to you prepaid.

Winplus makes no other warranty of any kind aside from the limited express warranty stated herein.

WINPLUS AUSTRALIA / HONG KONG

LIMITED WARRANTY

This Yada product is warranted against faulty workmanship for a period of 2 years from date of purchase. Liability is limited to replacement of the product and claims for associated or consequential loss or damage will not be accepted. Warranty is void and does not apply if the product has been damaged or rendered faulty by accident, abuse, misuse, incorrect application or if the product has been modified or tampered with. Proof of purchase is required to validate warranty claims. If this product is faulty, simply return it to the place of purchase with your receipt for a replacement product. No refunds or credits will be issued. Replacement is limited to a Yada product of the same or similar model.

► Package Content



Speakerphone



Microphone
Extension



12V/24V Car Charger

► Installations

⚠ IMPORTANT: Before installing the YD-V36, make sure:

- Vehicle is parked in a safe area
- Car engine is OFF
- Emergency brake is set

Your YD-V36 may be installed in your vehicle's cup holder.

- Make sure that the device is secure and firmly placed in the cup holder
- Adjust the angle of the speaker and the microphone for better performance
- Place the microphone extension behind the speakerphone and adjust the angle accordingly for maximum sound quality

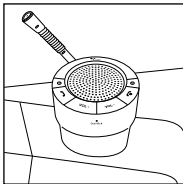

NOTE: The microphone extension is optional. Depending on the location of the cup holder, the microphone extension may increase mic sound quality.

Battery Operations

The YD-V36 is equipped with a built-in rechargeable Li-Polymer battery, which provides better than normal phone battery life span.

NOTE: The YD-V36 Speakerphone battery comes pre-charged, however the battery will discharge if the device is not used for a long time.

A. Low Battery Indication

Recharge battery when:

- Indicator light turns red and flash 4 times every 30 seconds

B. Charging

Follow the steps below when charging the YD-V36 Speakerphone:

- Insert the charging cable to the charging port of the YD-V36
- Plug the cable to the vehicle's 12V power port
- When the device is in charging mode, the red indicator light is on indicating that charging is in progress

NOTE:

- Standard charge time is around 2.5 hours
- Battery indicator light will turn off once fully charged
- Disconnect the charger cable once the battery is fully charged

⚠ IMPORTANT: Do not leave the YD-V36 Speakerphone charging in the vehicle unattended.

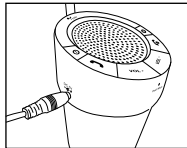

NOTE:

- To charge the unit at home, use a 12V DC to AC convert
- Do not attempt to remove the battery from the YD-V36

Operations

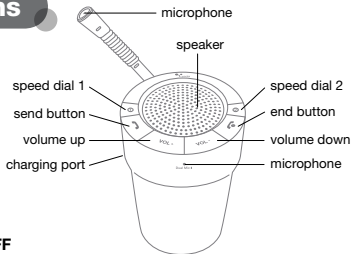

A. Power ON/OFF

To turn the YD-V36 ON:

- Press and hold **End** button for about 5-6 seconds
- Release after hearing indication tone
- The blue LED indicator will flash every 3 seconds

To turn the YD-V36 OFF:

- Press and hold **End** button for 3 seconds
- Release after hearing indication tone
- The red LED indicator will flash 5 times

NOTE:

- YD-V36 will automatically Shut Off after 10 minutes with no connection to a mobile phone

B. Pairing/Linking

Pairing Bluetooth® enabled devices like mobile phones with the YD-V36 Speakerphone authorizes hands-free communication. This step only needs to be performed once.

Before Pairing the YD-V36 Speakerphone:

- Ensure the YD-V36 is fully charged
- Ensure the YD-V36 is OFF
- Ensure the Bluetooth® on your mobile phone is activated

Follow the steps below to pair your YD-V36 with your mobile phone:

- Press and hold **End** button for 7-8 seconds
- Release as soon as the LED indicator alternately blinks red and blue

NOTE: YD-V36 is now in pairing mode

- Activate the Bluetooth® settings of your mobile phone

NOTE: The following steps are general procedure; to access Bluetooth® Menu for your mobile phone, please refer to the User Manual.

- Select SET-UP or CONNECT from your mobile phone menu
- Find and select OPTION to discover Bluetooth® devices; establishing a connection may take several minutes
- If found, phone display should indicate **YD-V36** device was detected or Select "**YD-V36**" from the list
- Phone should give you a prompt asking if you want to pair the device
- Select OK or ACCEPT and wait for prompt to enter passkey or PIN
- Enter the code **0000**
- Select "OK" to pair and connect the YD-V36 and the handset

NOTE: If the YD-V36 and mobile handset did not successfully pair, follow the steps below to retry pairing:

- Turn the YD-V36 OFF
- Turn OFF all other Bluetooth® devices before starting the pairing process
- Repeat the pairing instructions from the beginning

⚠️ IMPORTANT:

- After successfully pairing the device with your phone, the YD-V36 will always connect with your phone every time it is powered ON. No need to redo the pairing process unless the pairing information has been deleted
- The YD-V36 will connect to the last paired device every time it is powered ON

▶ Button Functions And Operation

Functions	YD-V36 Status	Operation
Cancel Calling	Calling	Press End button once
Answer a Call	Ringing	Press Send button once
Reject a Call	Ringing	Press End button once
End a Call	During a Call	Press End button once
Volume Up	During a Call	Press VOL+ button
Volume Down	During a Call	Press VOL- button
Microphone Mute	During a Call	Press Send button twice (consecutively)
Cancel Microphone Mute	During a Call (Microphone Mute)	Press Send button twice (consecutively)
Call Transfer from YD-V36 to Mobile Phone	During a Call	Press and hold Send button for 2 seconds, release after hearing indication tone
Call Transfer from Mobile Phone to YD-V36	During a Call	Press and hold Send button for 2 seconds, release after hearing indication tone
Redial Last Number	Standby Mode and Connected to a Device	Press Send button twice (consecutively)
Voice Dial	Standby Mode and Connected to a Device	Press Send button once
Speed Dial 1	Standby Mode and Connected to a Device	Press ① button once, to dial the phone number stored on the button
Speed Dial 2	Standby Mode and Connected to a Device	Press ② button once, to dial the phone number stored on the button

NOTE: Not all mobile phones support all functions listed above. Please refer to your mobile phone's user manual for further information.

Program Speed Dial Number

1. Make sure your mobile phone is connected with the YD-V36.
 2. On your mobile phone, go to the contact that you want to store on the Speed Dial.
 - Under the phones menu, select transfer contact
 - Transmit via Bluetooth® and select **YD-V36**
- NOTE:** Transferring phone contact steps are different from each mobile phone. Please refer to your phone user manual for more information.
3. After successful transfer, you can press button **①** or **②** to Speed Dial stored phone numbers.

Set the last received call to Speed Dial Number

Simply press and hold button **①** or **②** for 3 seconds when receiving a call, during a call, after a call or rejected a call to store the last received call to Speed Dial button **①** or **②**.

Clear Speed Dial Numbers

Press and hold button **①** and **②** simultaneously for 2-3 seconds

Care And Maintenance

- Turn OFF the YD-V36 when not in use
- Do not let the YD-V36 be in contact with liquid as it is not waterproof. Avoid putting it in places where there is excessive moisture and humidity
- Do not expose the YD-V36 to direct sunlight nor place in areas with high temperature, as it may result in an explosion
- If the YD-V36 is not in use for a prolonged period, store in a cool, dry place, free from moisture, humidity and dust
- Do not use abrasive cleaning solvents to clean the YD-V36
- Do not expose the YD-V36 to contact with sharp objects as this will cause scratching and damage
- Do not stick anything inside the YD-V36 as this may damage internal components
- Do not attempt to disassemble the YD-V36, as it does not contain serviceable components

- Only charge the YD-V36's built-in battery in accordance with the instructions of this user guide
- Do not disassemble the device as it may expose you to dangerous voltages or other risks. Incorrect reassembly can cause electric shock when the YD-V36 is subsequently used
- Avoid charging the YD-V36 in extremely high or low temperatures
- It's recommended to charge the YD-V36 immediately whenever low battery power is encountered to prolong durability & standby time of battery

▶ Troubleshooting

If you are unable to hear the person on the other line clearly, do the following steps while conversation is in ongoing:

- Adjust the volume to maximum in your YD-V36 or
- Request the person on the other line to adjust his/her mobile phone volume to maximum

If there is a strong echo resounding from the person on the other line:

- Transfer the call to mobile phone
- If echo disappeared, transfer the call again from mobile phone to YD-V36 and lower the loudspeaker volume until echo is eliminated
- If the echo still remains, this means the echo is generated by the network service provider or mobile phone itself

If the speaker volume of the YD-V36 is too low or too high and seems impossible to adjust it:

- Adjust the volume directly on the phone
- Fine tune it using the volume control of the YD-V36

If the YD-V36 charging indicator is not lighting up or the device is not charging:

- This happens when the battery is completely depleted and if the device is not used for a while.
- The red LED may take awhile to light up and start charging
- Leave the device plugged and charging for about 4 hours to completely charge the device

If you are unable to connect your speakerphone and mobile handset, please try the following:

- Ensure the YD-V36 is paired with your mobile handset and is fully charged
- Ensure your mobile handset's Bluetooth® feature is activated. Please refer to your mobile handset user guide for specific instructions
- Ensure the YD-V36 is within a maximum of 10 meters of your mobile handset(s) or Bluetooth® enabled device and there are no obstructions, such as wall or other electronic devices, in between as it may cause interference transmission
- If all the above steps do not resolve your problem, please turn OFF both the phone and the device and go through the pairing process

The YD-V36 Speakerphone is compliant with and adopts the Bluetooth® Specification V2.1 + EDR. However, interoperability between the device and other Bluetooth®-enabled products is not guaranteed because it depends on compatibility. For more information on the compatibility between the device and other Bluetooth®-enabled products, please contact Customer Service.

Customer Service / Contact Us

For questions or issues regarding the product, please visit www.letsyada.com or contact Winplus in your area/region to speak to our customer service representative:

Winplus USA	Tel.: 866-294-9244
	Tel.: 909-752-3074
Winplus Europe	Tel.: 44-1440-713888
Winplus Australia	Tel.: 61-3-9720-4143
Winplus New Zealand	Tel.: 64-9-5254575
Winplus Asia	Tel.: 852-2798-8932

You can also contact us online by visiting www.winplus.com for more information about the product.

IF YOU ARE EXPERIENCING ANY ISSUES WITH THE PRODUCT DURING OPERATION, DO NOT RETURN THE PRODUCT TO THE STORE. CONTACT WINPLUS DIRECTLY FOR INSTRUCTIONS ON HOW TO RETURN/EXCHANGE THE PRODUCT.

▶ FCC / ICC

Federal Communication Commission Interference Statement

This equipment has been tested and found to comply with the limits for a Class B digital device, pursuant to Part 15 of the FCC Rules. These limits are designed to provide reasonable protection against harmful interference in a residential installation. This equipment generates, uses and can radiate radio frequency energy and, if not installed and used in accordance with the instructions, may cause harmful interference to radio communications. However, there is no guarantee that interference will not occur in a particular installation. If this equipment does cause harmful interference to radio or television reception, which can be determined by turning the equipment off and on, the user is encouraged to try to correct the interference by one of the following measures:

- Reorient or relocate the receiving antenna
- Increase the separation between the equipment and receiver
- Connect the equipment into an outlet on a circuit different from that to which the receiver is connected
- Consult the dealer or an experienced radio/TV technician for help

This device complies with Part 15 of the FCC Rules. Operation is subject to the following two conditions: (1) This device may not cause harmful interference, and (2) This device must accept any interference received, including interference that may cause undesired operation.

FCC Caution: Any changes or modifications not expressly approved by the party responsible for compliance could void the user's authority to operate this equipment.

IMPORTANT NOTE

FCC Radiation Exposure Statement:

This equipment complies with FCC radiation exposure limits set forth for an uncontrolled environment. End users must follow the specific operating instructions for satisfying RF exposure compliance.

This transmitter must not be co-located or operating in conjunction with any other antenna or transmitter.

IC Statement

Operation is subject to the following two conditions:

1. This device may not cause interference and
2. This device must accept any interference, including interference that may cause undesired operation of the device.

This device has been designed to operate with an antenna having a maximum gain of 0 dBi. Antenna having a higher gain is strictly prohibited per regulations of Industry Canada. The required antenna impedance is 50 ohms.

IMPORTANT NOTE:

IC Radiation Exposure Statements:

This equipment complies with IC radiation exposure limits set forth for an uncontrolled environment. End users must follow the specific operating instructions for satisfying RF exposure compliance.

This transmitter must not be co-located or operating in conjunction with any other antenna or transmitter.



WINPLUS

NORTH AMERICA	820 South Wanamaker Avenue, Ontario, CA 91761	Tel: 310-638-0588 Fax: 310-496-2740
EUROPE	Unit 4, Two Counties Estate, Falconer Road, Haverhill, Suffolk CB9 7XZ, U.K.	Tel: 44-1440-713888 Fax: 44-1440-713889
AUSTRALIA	Unit 2, 991 Mountain Hwy Boronia, Victoria, Australia, 3155	Tel: 61-3-9720-4143 Fax: 61-3-9720-4165
NEW ZEALAND	22-24 Olive Road, Penrose, Auckland, New Zealand	Tel: 64-9-5254575 Fax: 64-9-5256817
ASIA	Suites 6-11, 7th Floor, Corporation Park, 11 On Lai Street, Shatin, N.T., Hong Kong	Tel: 852-2798-8932 Fax: 852-2795-0241

© 2010 Winplus North America Inc. All Rights Reserved. Winplus, the logo design, and Yada are trademarks or registered trademarks of Winplus North America Inc. The Bluetooth® word mark and logos are owned by the Bluetooth SIG, Inc. and any use of such marks by Winplus North America Inc. is under license.